



BWT AQUA STONE 4



FOUNTAIN FOR THE SUPPLY OF DRINKING WATER

REALIZED IN COMPLIANCE WITH DM 25/12 AND D.M. 174/04

ATTENTION THIS EQUIPMENT REQUIRES FROM REGULAR MAINTENANCE

PERIODIC TO THE END FROM GUARANTEE I REQUIREMENTS FROM POTABILITY OF TREATED WATER ED

THE

MAINTENANCE OF IMPROVEMENTS AS STATED BY THE MANUFACTURER

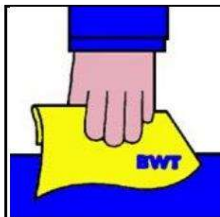

GENERAL NOTES TECHNICAL DATA INSTALLATION STARTING ORDINARY MAINTENANCE

EXTRAORDINARY INTERVENTIONS

INSTALLATION AND USE INSTRUCTIONS

INDEX

	Page
Generality	3
Symbols/warnings	3
Device description	6
Technical data	7
Positioning	8
Installation	8
Flow rate adjustment	10
Maintenance	10
Periodic sanitization of the drinking fountain	10
Guarantees, Disposal of the drinking fountain	12
Controls	14
Intervention register	15



REGULATORY COMPLIANCE

FROM REFERENCE

The fountains indicated in this installation, use and maintenance manual of the series:

BWT AQA Drink Stone 4 comply with the general safety requirements set out in the following legislation:

- Ministerial Decree 25/12 regulation containing technical provisions concerning equipment for the treatment of drinking waters.
- Ministerial Decree 174 of 6 April 2004 concerning materials and objects that can be used in fixed systems for the collection, treatment, supply and distribution of water intended for human consumption. • Legislative Decree n°31/2001 "implementation of Directive 98/83/EC relating to the quality of water intended for human consumption"...
- 73/23/EEC and meets the specific requirements of the UNI EN ISO 12100-1:2005 and UNI EN ISO 12100-2 standards: 2005.

If the optional water cooler is present:

- For the electrical equipment, the appliance complies with the Standards EN 60204-1 (1992), 44/5 (1993) CEI 64-8 (1993) EN 60335 and EN 60335-2-24 (safety of electrical systems domestic and similar use) and the regulations relating to electromagnetic compatibility EN 50081-50082.
- DL 151 of 22 July 2005 regarding the reduction of the use of dangerous substances in electrical and electronic equipment, as well as waste disposal.

BWT ITALIA Srl operates with a certified Quality System in compliance with the provisions of the UNI-EN ISO 9001:2008 Regulation, with Certificate no. 677 issued by the CERTIQUALITY body.

Furthermore, we inform you that BWT ITALIA Srl has obtained certification from the CERTIQUALITY body as a company that operates in compliance with the UNI EN ISO 22000:2005 – cat. J, Certificate no. 17771, relating to the design, production, installation, sale and technical assistance of public and private supply systems of refined water and/or with gas additives for food use.

GENERALITY

Dear Customer,

BWT ITALIA thanks you and congratulates you for your preference, and is pleased to include you among its already numerous customers. The fountain you purchased was designed and built by highly qualified personnel with considerable experience in the sector. The construction highlights the high quality standards that have always characterized our equipment.

The drinking fountain does not present any danger for the user if installed and used according to the instructions provided by the manufacturer. The user must consult them and follow the instructions provided on the same.

Before undertaking any operation on the fountain, it is essential to read this manual carefully, paying particular attention to the "SAFETY WARNINGS" chapter.

Store the manual near the fountain, in a dry place protected from atmospheric agents. The manual must be kept until the final disposal of the appliance.

GLOSSARY

MANUFACTURER: this term identifies the manufacturer of the drinking fountain, reporting his name on the EC Declaration of Conformity.

MACHINE/APPLIANCE/FOUNTAIN: the term machine, appliance or fountain identifies the water dispenser.

EXPOSED PERSON: any person who is near the drinking fountain.

RESIDUAL RISKS: this term identifies all the dangers that are not evident and cannot be eliminated in the design phase of the machine, as adequate countermeasures would compromise the functioning of the fountain

SYMBOLS ADOPTED IN THE MANUAL



A very important text note precedes this for the protection of the health of exposed people and/or for the machine itself.

Attention



It precedes information regarding safety. Mark an operation not to be done.

Prohibited



It precedes information relating to the use of the equipment.

Informative note



Information relating to the disposal of the equipment precedes it.

Informative note

GENERAL WARNINGS

- Read this manual carefully before using the appliance.
- The technical information contained in this manual is the property of BWT ITALIA Srl; Even partial reproduction of this manual is prohibited. manual carefully hand them over to the new owner
- Store the appliance; The It is in case of transfer



Make sure that the appliance has not been damaged during transport. Packaging materials, being potential sources of danger, must not be left within the reach of children and must also be disposed of in compliance with current regulations.

The packaging material is 100% recyclable.

Attention



The appliance is made of heavy weight material. Careful handling during transport and installation is recommended, in order to avoid damage to people and property.

In particular, we recommend fixing to the ground as indicated in this manual

Attention



Attention

Do not use damaged appliances. In the event of abnormal functioning (water leaks, etc.), close the appliance's supply water shut-off valve and finally call the authorized technical assistance centre.



Attention

The manufacturer rejects any responsibility in the event of modifications and errors in the hydraulic connection, caused by failure to comply with the instructions given in the installation manuals, circumstances of use of the equipment for purposes other than those intended. of the equipment. They are prohibited

FAILURE TO COMPLY WITH THESE INDICATIONS WILL CAUSE THE IMMEDIATE VOIDING OF THE WARRANTIES.

WARNINGS FROM SAFETY



Attention

Read the instruction manual carefully and store it carefully in a dry and protected place; keep it near the device so that you can consult it if necessary.

- Do not leave the material used for packaging (pallet, box, bag, staples, etc.) within the reach of children. It is advisable to keep the packaging for future reuse; otherwise dispose of the materials according to the relevant regulations in force.
- If the appliance is damaged or has visible defects or malfunctions, we recommend that you do not use it and do not attempt to disassemble or tamper with it. You must contact the retailer directly for repairs.
- Do not stack the appliance on top of other appliances.
- Place the appliance away from heat sources.
- Installation, extraordinary maintenance and repairs must be carried out only and exclusively by qualified and specialized personnel authorized by the manufacturer; always contact your dealer or authorized technical assistance center of BWT ITALIA Srl

The installation must be carried out by qualified personnel capable of issuing a regular declaration of conformity in accordance with the provisions of Ministerial Decree no. 37 of 22 January 2008 relating to the reorganization of the provisions regarding the installation of systems inside buildings.



Attention

The water supplied to the appliance must be exclusively drinking water, with characteristics that comply with the limits set by Legislative Decree 31/2001, relating to the quality of water intended for human consumption.

It is absolutely forbidden to connect the appliance to sources of water other than drinking water. Do not use the appliance to dispense volumes of water greater than those indicated in the technical data or at pressures lower than 2.5 or higher than 3 bar.

- Do not climb or sit on the drinking fountain.
- Use only original accessories.
- Never immerse the fountain in water.
- Do not clean the fountain with jets of water.
- In case of inappropriate use, not compliant with the instructions for use, or tampering with the appliance, the Manufacturer is not responsible for any damage caused to people, animals or things.
- When the appliance is put out of use for scrapping, it must be made unusable, e.g subsequently dispose of it according to the relevant provisions in force. Optional water cooler if present.
- Do not use adapters to connect the appliance to the electrical socket. (If there is a refrigeration unit water supplied)
- Do not remove the plug from the electrical socket with damp or wet hands.
- Do not pull the power cord or the appliance to remove the plug from the electrical outlet.

- In case of anomalies (water leak or other), disconnect the electricity supply and position the valves so as to leave the appliance in by-pass.
- Check the presence of adequate earthing and connect the relevant cable to the metal structure of the drinking fountain.
- Do not use the drinking fountain in explosive environments.
 - The water cooler, if present in the fountain, must always remain electrically powered.
- Do not clean the cooler with jets of water.
- Carry out all start-up, cleaning or maintenance operations with the appliance turned off, in the absence of water supply and with the electrical plug disconnected from the 230V 50Hz socket.
- **When positioning the fountain, make sure that the support surface is adequate for the weight of the fountain itself and that the support surface is suitable for correct fixing with chemical anchors.**

The manufacturer exempts itself from any liability in the specific cases contemplated below:

- improper use of the drinking fountain;
- use contrary to specific national regulations (power supplies, installation and maintenance);
- installation carried out by unauthorized personnel;
- Assembly and fixing on an unsuitable support. • Connection to non-potable water arrival lines.
 - Use of components in contact with water intended for human consumption that do not comply with specific national regulations
- unsuitable operating environment temperature or environments that are too humid;
- deficiencies in scheduled maintenance;
- unauthorized modifications or interventions;
 - use of non-original or model-specific spare parts;
- total or partial failure to comply with the instructions.

PRECAUTIONS FROM HYGIENIC/SANITARY CHARACTER

- For hygienic reasons, during maintenance, do not touch the internal parts of the appliance without first complied with normal hygiene procedures.
- If water has not been dispensed for more than 24 hours, dispense at least approximately 2 liters of water before consumption. The appliance must be used in full compliance with hygiene regulations to guarantee the quality of the water.

PACKAGING

OPENING THE PACKAGE

The drinking fountain is generally shipped on a pallet. In addition, the dispensing area is protected by a suitable easily removable plastic protection film.

The packaging can be removed before taking the appliance to the installation site to await the technician.

Avoid damaging the surface of the fountain. It is advisable to keep the packaging for future reuse. Once the packaging has been removed, check that the appliance has not been damaged during transport. If this is the case, contact your dealer. Check the presence of the supplied accessories which must be contained inside the box. The manufacturer reminds you that the warranty does not cover damage resulting from transport or from the unloading and handling phases. Do not leave packaging materials unattended as they are potential sources of danger. If necessary, arrange for disposal in accordance with local regulations in force on the matter.

GOODS CONTROL

Once the packaging has been removed, check that the fountain has not been damaged during transport. If this is the case, contact your dealer. Check the presence of the supplied accessories that must be contained inside.

DESCRIPTION OF THE APPLIANCE

The BWT AQA Drink Stone 4 fountains are drinking water dispensers that must be connected directly to the drinking water network, in order to dispense water by inserting special microfiltered BWT Bewapur filters. (BWT Bewapur filters and heads sold separately)

Limitations of use

It is absolutely forbidden to connect the fountain to water sources other than drinking water. Do not use the appliance to dispense volumes of water greater than those indicated in the technical specifications.



CAUTION Environmental conditions for storage and operation

While awaiting installation, the appliance must be stored in a vertical position at an ambient temperature between 5°C and 40°C, and free of humidity.

During operation of the fountain, it must be protected from frost, ambient temperatures below 2 °C could damage the hydraulic system inside the fountain.

The manufacturer declines all responsibility in the event of breakages and/or damage from flooding caused by frost.

It is recommended to secure (close) the fountain, after removing the water present in the pipes inside the fountain itself, in the winter period.

GENERAL TECHNICAL DATA

Designed for outdoor use in urban and recreational areas, the BWT AQA Drink Stone 4 fountain was born from BWT's vast experience with Water Houses.

The BWT AQA Drink Stone 4 fountains are designed as a multiple water dispensing point. The drinking fountain has a pleasant and modern design.

clutter



Their design and colors are contemporary and adapt to multiple urban contexts, offering an **educational message: refill your own bottles and reduce plastic waste.**

They are designed with a structure in vibro-compressed concrete and AISI316 stainless steel. The water bottle refill area is covered and made of AISI 316, to guarantee maximum hygiene.

Thanks to its four simultaneous withdrawal points and high construction quality, it is the best solution for installations where intense use is required.

The water is dispensed via vandal-proof metal buttons: they are located on the sides of the dispensing area and are in a convenient position even for disabled people.

AQA BWT AQA Drink Stone 4 fountain with "mushroom" shape, with trapezoidal base body, with square base with maximum dimensions of 419x419 mm (larger base) - 350x350 mm (smaller base) x total height of the fountain 1295 mm

The basic body of the fountain is made of continuously formed white vibrated concrete, with high frequency vibration designed to obtain better compaction of the mixture; packaged with aggregates with controlled grain size and subsequently smoothed; Italcementi 52.5 cement, super-plasticising additives suitable for reducing the water/cement ratio; external surface finishes with a stone white effect, protected with anti-degradation water-repellent paint for exteriors with a natural effect, resistant to yellowing and chalking.

In the base of the fountain there are holes both for the passage of the drinking water and waste water pipes and for fixing the product to a solid and stable concrete base with a threaded bar (chemical anchors).

Model size _____ BWT AQA Drink Stone 4

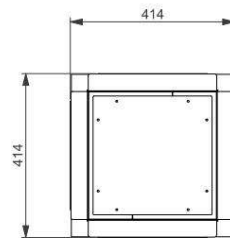
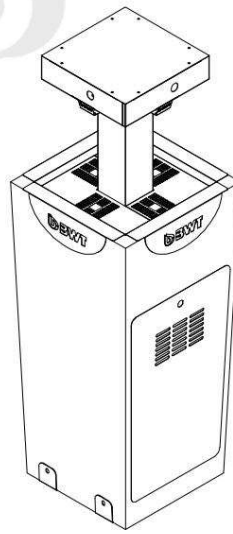
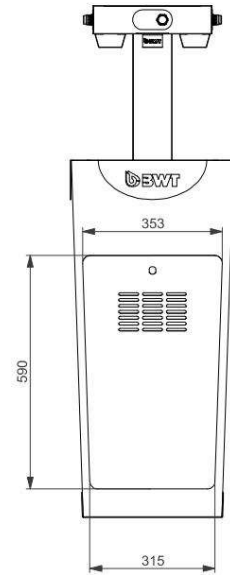
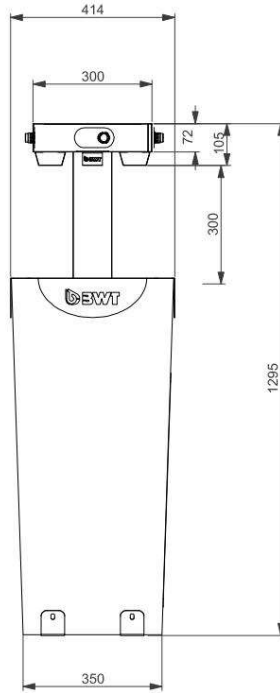
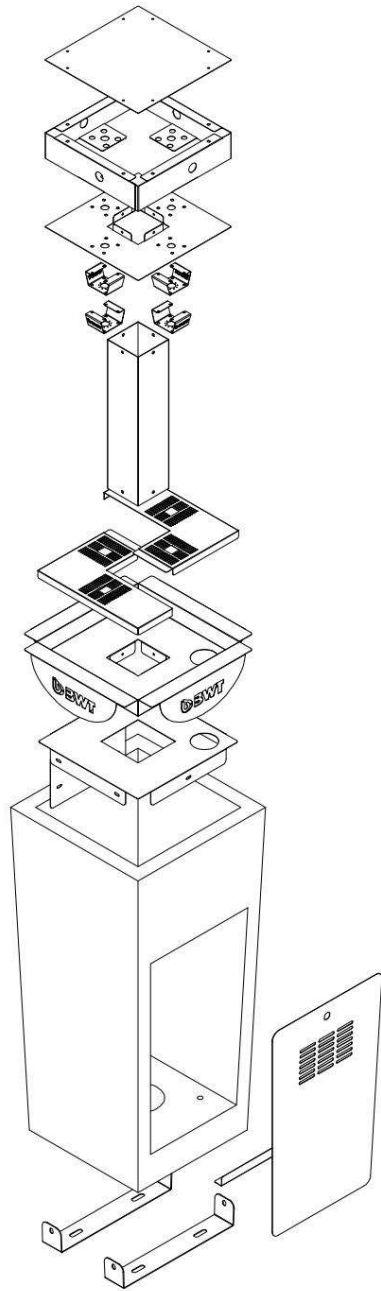

TECHNICAL FEATURES

Name	BWT-AQA Drink STONE 4
Max flow rate lt/min (adjustable) for each sampling point	2,5
Operating temperature	4 – 32 C°
Max water operating pressure (if higher, provide a pressure reducer capable of lowering the latter value in the range 1 – 3 bar)	3 bar
Weight of the fountain	180 kg approximately
If water cooler is present:	Optional
Air-cooled condenser	open
HP Power	1/8
Flow rate max lt/min	2,5
Max hourly cooling capacity lt (thermal delta 10 °C)	75
Volts/Hz. Standard	220/240 – 50 Hz
Chilled water tank capacity lt	7,5

POSITIONING

The fountain must be handled with care; falls and impacts can damage it even without external damage. The fountain must be installed only by authorized technical personnel, who will take care of its maintenance and periodic sanitization.

Securely secure to the ground using threaded rods with chemical anchor and safety brackets.

Adjust the base so as to have a perfect horizontal installation surface.

It is forbidden to place the appliance near direct or indirect heat sources.

INSTALLATION

The fountain must be placed and fixed on a suitable level floor.

Attention plan: the foundation support surface useful for fixing the fountain must always be use the threaded rods and the chemical anchor supplied with the fountain.

perfectly in _____



Position and fix the fountain perfectly vertically. If the fountain is positioned non-vertically, the water flows will not have a correct orientation.

After positioning the fountain, it is necessary to proceed with the operations of connecting the drinking water supply and drainage.

The warranty automatically lapses in the event of: ÿ
unauthorized installation or without following the instructions provided;
ÿ problems due to hydraulic supply defects;
ÿ comply with the national regulations in force in the country of installation.

CONNECTIONS:



Warning The water inlet/drain pipes must be separated.

The following interventions must be carried out by specialized and competent personnel.

Water connections (drinking water)



Do not make temporary connections.

It is mandatory to insert a water shut-off tap before the connection point. It is advisable to provide a suitable well near the fountain.

The mains water supply must guarantee:

-that there are no overpressures;

-a pressure as indicated in the technical characteristics table;

-maximum recommended water network pressure 3 bar. If the pressure is higher, a pressure reducer calibrated to a maximum of 3 bar must be installed after the shut-off valve.

Check that the characteristics of the water system comply with what is indicated by the manufacturer.

Use only hoses with fittings certified for food (for food use), preferably made of plastic material.

For waste water, provide a pipe connecting to the gray water sewer system if present; if you do not have the possibility of connecting to the sewer system, use a disposable sump.

Proceed to connect the connection pipe to the water mains after inserting two filters internally on the line BWT Bewapur (optional) in parallel preceded by a hydraulic shut-off valve (not included in the supply),

Check the hydraulic tightness of the entire fountain.

It is advisable to insert an additional pre-filter in series with the water supply line in case the water is not perfectly clean.

The connections are made using quick couplings such as John Guest or similar and specific pipe for PVC drains with socket connection, or similar.

Att.: diameters that are too small could cause malfunctions of the entire system!!

Att: when using the quick coupling system it is necessary to pay attention when cutting the pipe which must be carried out with a special pipe cutter so that it is clean, perpendicular and the cutting edge is not crushed under penalty of losing the joint.

Furthermore, the hose must be pressed all the way into the fitting.

ELECTRICAL CONNECTIONS SE COOLER PRESENT WATER

The refrigeration appliance (if applicable) complies with the safety regulations in force in the European Union and therefore has the CE marking. The manufacturer declines all responsibility for damage to people or things resulting from connecting the chiller to an electrical network that does not comply with the regulations and legislation in force in the country in which the chiller is installed. In particular, the electrical line to which you connect your refrigerator must be equipped with a high-sensitivity differential switch (life-saving) with an operating current not exceeding 30mA and an earthing system in compliance with current regulations and legislation. Provide an electrical power supply tower with energy meter and differential switch.

In any case, it will be necessary to verify that the characteristics of the electrical power supply satisfy those of the chiller, reported in the technical data sheet. If the electric power cable is damaged, it must be replaced with a new one with similar characteristics. It is forbidden to attempt to repair it.

To make the electrical connections, the general regulations for the installation, preparation and commissioning of electrical systems in force in the country in which the appliance is installed must be observed. Pay particular attention to the earthing system.

In order to guarantee the safety of people and the appliance, the following rules must be respected.



Check that the characteristics of the power supply are compatible with the technical data of the appliance.

It is forbidden to use adapters or make joints on the cable.

After having verified that the characteristics of the electrical system comply with what is indicated by the manufacturer and the safety regulations, proceed as described:

Attention

Connect the IP 44 two-phase industrial plug, 2p+earth poles supplied, to your appropriately protected electrical mains socket.



IP 44-pole 2p+earth two-phase industrial plug

“GREY” WATER DISCHARGE IN SUB-IRRIGATION

The dispersion of water defined as "grey" in the superficial layers of the soil (sub-irrigation) is a particular water treatment and disposal system that can be adopted if suitable receptor bodies are not available and if the characteristics of the soil and subsoil do not present contraindications.

It consists of introducing excess water, through special pipes, directly under the surface of the ground where it is absorbed and gradually assimilated and degraded biologically in aerobic conditions.

The excess water from the fountain (not used drinking water plus rainwater) reaches a prefabricated concrete sump, also sealed, through a sealed pipe, which serves to guarantee uniform distribution of the water along the entire equipped with a filtering valve. That dispersing pipe and it allows a certain interval between one injection of water and another into the sub-irrigation network, so as to facilitate oxygenation and absorption of the soil.

The dispersing pipe is preferably made of continuous tubular elements in heavy PVC (UNI 302), with a diameter of 100-120 mm and with slots, made below and perpendicular to the axis of the pipe, spaced 20 - 40 cm and 1 to 2 cm wide cm. The dispersant pipe must have a slope between 0.2% and 0.5%.

It is generally placed in a trench of adequate depth, not less than 60 cm and not more than 80 cm, with a width at the base of at least 40 cm. The bottom of the trench for at least 30 cm is occupied by a bed of washed crushed stone with a size of 40/70. The dispersing pipe is placed in the center of the bed

crushed stone.

Before being covered with the excavated soil, the upper part of the gravel mass must be protected with a layer of suitable material which prevents clogging of the soil above but at the same time guarantees the aeration of the drainage system. A particularly suitable material for this purpose is the so-called "non-woven fabric". Once the work is finished, the top of the trench must be raised compared to the

adjacent land in order to avoid the formation of depressions and therefore valley lines and the penetration of rainwater into the drainage network. The dispersing conduct can be:

- unique;
- branched;
- on multiple lines in parallel.

Generally, given the modest quantity of gray water to be dispersed, the solution with a single pipe is sufficient.

Warnings: If the land has a significant slope, the adoption of a sub-irrigation drain must be carefully evaluated in relation to the possible occurrence of landslides connected to the geomorphological and geotechnical characteristics of the lands involved. For hygienic and functional reasons, trenches with dispersing pipes must be located away from buildings, paved areas or arranged in such a way as to prevent the passage of air into the ground.

Reference Italian legislation: Legislative Decree 11 May 1999, n. 152

Title: "Provisions on the protection of waters from pollution and transposition of Directive 91/271/EEC concerning the treatment of urban waste water and of Directive 91/676/EEC relating to the protection of waters from pollution caused by nitrates from agricultural sources "

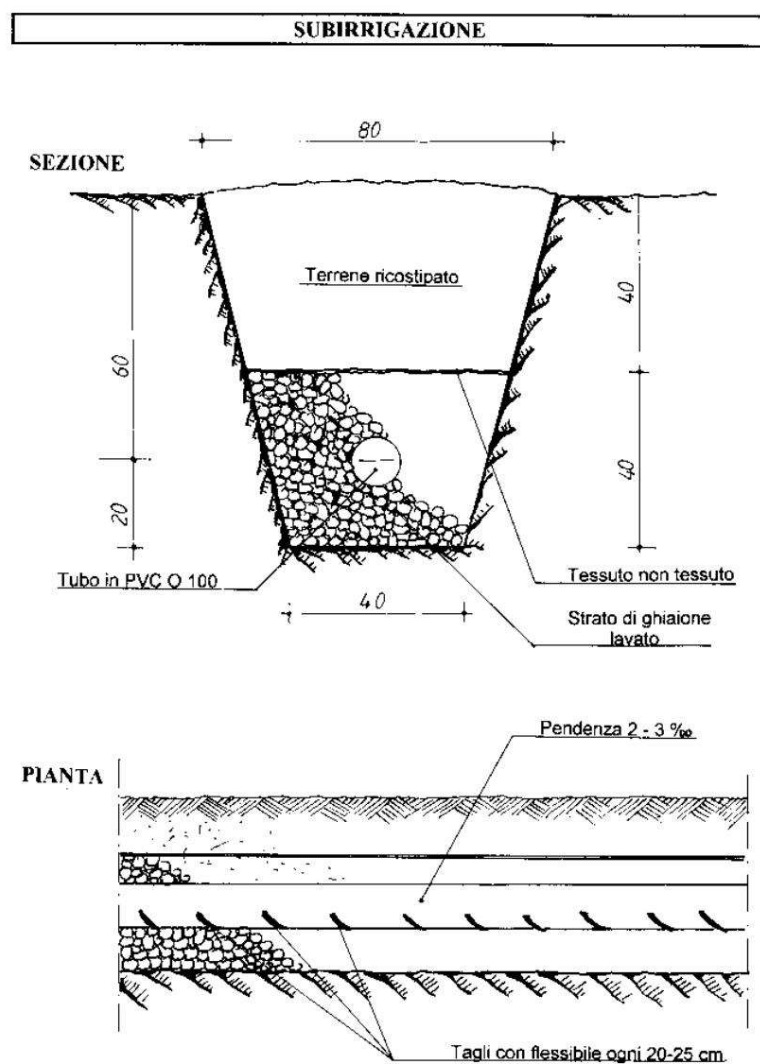

REGULATION OF THE CHILLER TEMPERATURE

The temperature of the water supplied by the equipment is adjustable (depending on the ambient temperature and the temperature of the water to be treated) by means of the thermostat positioned inside the fountain in the upper part of the refrigerator.

FLOW REGULATION

FROM DELIVERY

It is possible to adjust the flow rate of each individual fountain dispensing point (4) using the appropriate tap located under the specific dispensing button.

To carry out this operation, unscrew the button cover by acting on the ring nut, adjust the desired flow rate with a slotted screwdriver. Refit the button cover by tightening the fixing ring.

USE OF THE FOUNTAIN

After positioning the cooler inside the fountain if present, and after its correct hydraulic, drainage and electrical connection, you can proceed with the FIRST START-UP of FILLING the cooling tank:

The cooling tank must be filled with clean, fresh, potable water.



The appliance cannot work with an empty tank. Do not use other liquids other than drinking water for filling. The evaporator coil is placed externally tangential to the water cooling tank and protected by thermal insulating material.

After having prepared all the connections, proceed with the start-up (commissioning) of the same. After it has been started, the appliance switches off automatically when the set temperature is reached.



Adjust the cooling water waste of the water-cooled refrigerator condenser with a graduated instrument (not included in the supply). The waste flow rate must be greater than or equal to 50 cc/min = 3 lt/hour. The adjustment is carried out with the appropriate needle valve present. The refrigerator must be running.

Water is discarded only when the refrigeration compressor is running.

The water, also in this case, must be drinkable and above all clean to avoid clogging the passages of the condenser and regulation valves.

The maximum noise level of the appliance, if installed correctly, is less than 70 dB. After the compressor has stopped for the first time the unit is ready to operate.

Open the dispensing taps individually and in succession to allow correct filling of all lines. (dispense at least 10 liters per line).



Do not stop the operation of the appliance at night.



Even with insulated pipes, frost can damage the refrigeration appliance if left inactive and with the tank full at temperatures below 0 °C.

MAINTENANCE OF THE FOUNTAIN

PREMISE:

All maintenance operations, both ordinary and extraordinary, must be carried out with the fountain with the water connection closed. Any operation on the appliance must be carried out only after reading the instructions listed in the "SAFETY WARNINGS" chapter.

During the warranty period we are not responsible for any damage or malfunctions if due to failure to comply with the regulations in force.

The buyer is authorized to intervene on the machine only in the cases listed on the following pages.

As regards interventions not described or extraordinary, they can only be carried out by the Technical Assistance center or by the Dealer.

Cleaning and sanitation maintenance

The following table represents a guide to the scheduled cleaning and sanitization operations that must be carried out on the fountain, according to the suggested periodicity.

PART OF THE FOUNTAIN	TYPE OF INTERVENTION	INTERVENTION PERIODICITY			
		daily	weekly	monthly	half yearly
front and bodywork	cleaning		•		
dispensing spout	disinfection		•		
hydraulic circuit	disinfection			•	
Total appliance	sanitization/cleaning				•

USE

The times given in the table are indicative and refer to normal conditions of use. In

in any case refer to the Health Regulations of _____ place (Municipality and/or Country).

The frequency of the intervention is directly proportional to the severity of use of the machine.

EXTERNAL CLEANING

For good conservation of the fountain, it is necessary to follow scrupulous cleaning.

The general cleaning of the fountain must be carried out with the fountain turned off (in case of electricity) using neutral detergent products, diluted in water, with the use of a damp cloth.

Do not use solvent or alcohol based products.

The degree of protection of the electrical equipment guarantees protection against splashes; in any case it is forbidden to wet electrical connections, switches, buttons etc. with water.

TOTAL SANITIZATION OF THE FOUNTAIN (six-monthly)

It is good practice (essential in risky conditions) to completely sanitize the appliance every 6 months of dispensing to avoid possible bacterial contamination of the appliance.

For this operation we recommend requesting the intervention of qualified technical personnel equipped for this purpose, contacting the retailer or authorized assistance centre.

PERIODIC SANITIZATION OF THE REGULATOR (weekly) AND THE HYDRAULIC CIRCUIT (monthly or as needed)

If the fountain has not been used for a long period (de-powered for one or more weeks e.g. winter period) or when replacing the BWT BEWAPUR filter cartridge if present, it is mandatory to carry out periodic sanitisation when switched on again following the following procedures :

a) Dispense at least 10 liters of water by pressing the individual buttons alternately for a minimum of 20 seconds each; b) Sanitization is

carried out by introducing a specially designed sanitizing product such as BWT-ALLSIL inside the dispensing device using the dispenser supplied with the sanitization kit and following the procedure reported below; (kit sold separately)

c) Sanitize the dispensing spout (perlator) by unscrewing it and immersing it in the liquid BWT ALLSIL sanitizer for 15+20 minutes. Rinse the parts, insert them into the ring nut and screw them back on.

Note: BWT-ALLSIL is a product specifically designed for the disinfection and sanitization of water and systems. BWT-ALLSIL is very effective, it does not give rise to by-products, it does not leave taste or odor residues on the water subsequently dispensed and, as a final result, it enriches the water with oxygen, improving its quality and eliminating any microorganisms present.

For sanitizing the appliance, chlorine-based products which denote particular odors and fragrances, which make drinking water unappetising and unpleasant and, if used with different concentrations, would cause the daily intake levels of chlorine to be exceeded, are not recommended. chlorine.

PROCEDURE FROM USE OF THE BWT-ALLSIL DISINFECTANT LIQUID

Container/dispenser with quick couplings, (accessory not included - sold separately)

Wrenches, pliers or other tools are not to be used for the operation.

- A Dosing cap;
- B Equipment water inlet pipe;
- C Water outlet pipe of the disinfectant product dosing device;
- D Water inlet quick coupling;
- E Quick water outlet connection.

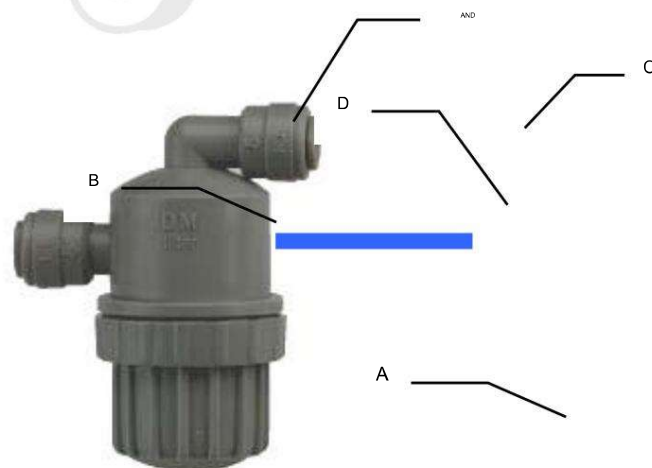

- 1 Close the fountain's water connection valve;
- 2 Apply the container/dispenser to the water supply pipe, replacing it with the BEWAPUR filter if provided using the pipes or insert near the inlet of the appliance downstream of the Bewapur filter. In any case, the distance between the container/dispenser and the appliance must not be greater than 1 metre;
- 3 Insert the two ends of the hose into the appropriate quick couplings until you hear a safety click. Insert the pipes according to the flow indications shown near the fitting itself;
- 4 Open the cap of the container/dispenser and fill it with BWT-ALLSIL up to the level of the red seal;
- 5 Open the water connection valve;
- 6 Press the room temperature water dispensing button for 3 seconds;
- 7 Repeat the procedure for all available dispensing modes (e.g. cold, cold carbonated.);
- 8 Wait about 30 minutes;
- 9 Close the appliance's water connection valve;
- 10 Disconnect the container/dispenser by pressing on the head of the fittings and removing the tubes.
- 11 Check the correct insertion of the tubes (hear the safety click when inserting the tubes);

12 Open the water connection valve;

13 Dispense at least 5 liters for each type of water available, in order to complete the cleaning of the water circuit.

NOTE

For cases where there is a high risk of pollution, we recommend contacting the retailer or authorized assistance centre.

DECOMMISSIONING AND SCRAPPING OF THE FOUNTAIN

TEMPORARY SHUTDOWN OUT OF USE

The fountain can remain unused or be turned off for a long period. In these cases, when you want to restart it, it is necessary to observe some instructions: If the dispenser has been turned off for more than 24 hours, dispense at

A) least 5 litres, of water (second the needs and according to the quality of the water);

If no water has been dispensed for more than 24 hours, dispense at least approximately 2 liters of water

B) before consumption;

C) Sanitize the dispenser as needed;

D) If the dispenser is equipped with filters or other water treatment systems, replace them accordingly the manufacturer's instructions;

The dispenser must be managed in full compliance with hygiene regulations to guarantee safety

E) quality of the product supplied.

PERMANENTLY TAKEN OUT OF USE FOR SCRAPPING

When the fountain is put out of use, it must be made unusable by removing the plug from the socket and cutting the power plug of the cable. Disconnect the appliance from the water supply line.

The materials making up the appliance do not require particular treatments other than being divided and grouped based on the type (e.g. ferrous, plastic, concrete, etc.).

Follow the regulations in force in the municipality and/or country where the appliance will be scrapped.

The waste must be disposed of according to current national practice, possibly using companies recognized and authorized for this service, or using municipal waste disposal areas.

WARRANTY

The ITALIAN legal guarantee terms apply to this fountain.

Exclusion of warranty rights

ÿ Failure to comply with the assembly requirements and the operator's duties will cause the exclusion of rights to the guarantee.

ÿ BWT ITALIA SRL assumes no responsibility for failures of the appliance or poor performance caused by an incorrect combination of materials, the introduction of corrosive products or deposits of iron and manganese, or for damage resulting from these reasons.

ÿ The manufacturer declines all responsibility in the event of modifications and errors in the electrical and hydraulic connections, caused by failure to comply with the instructions given in the installation or use manuals of the equipment in conditions other than those for which it was designed, in particular, with use of the drinking fountain with temperatures below zero degrees centigrade.

ÿ The manufacturer declines all responsibility in the event of breakages and/or damage from flooding caused by frost.

ÿ Failure to check and/or replace parts subject to wear automatically voids the warranty.

DISPOSAL WARNINGS



Tips for protecting the environment

The packaging material is recyclable, and we ask you to dispose of it according to the guidelines for recyclable materials in the appropriate container and contribute to environmental protection.

Since the equipment is made up of different materials, in the event of scrapping, it must be delivered directly to the collection centers following the normal disposal procedure.

Informative note

LIST FROM INITIAL CHECK

After carefully reading this instruction, completing the installation and before starting it, it is essential to check with the following list that all the operations have been carried out correctly. Use this form to request a free initial visit to our assistance centers located throughout the country.

RECORD	CHECKLIST	BUT	
User:	Is the installation point accessible?	ÿ	ÿ
Dealer:	Is there sufficient maneuvering space to allow maintenance?	ÿ	ÿ
Installer:	Is there a BWT BEWAPUR Filter inside the fountain (recommended)?	ÿ	ÿ
Drinking fountain type:	Is there a non-return valve upstream of the fountain?	ÿ	ÿ
Code:	Is a 230V protected two-phase IP 44 industrial type socket available, 2p+earth poles?	ÿ	ÿ
Serial No.:	Is the drinking fountain constantly supplied with drinking water?	ÿ	ÿ
Manufacturing date:	Is the water pressure constant and between 1 and 3 dynamic bars?	ÿ	ÿ
Inlet pressure:	Do you have declarations of conformity pursuant to Ministerial Decree 37/08?	ÿ	ÿ
Data: gg/mm/aa			

If one of the items in the CHECKLIST is not respected, it will not be possible to put the appliance into operation.

INTERVENTION REGISTER

CLIENT: _____

Drinking fountain model:

Data	Assistance sheet	Type of intervention	Specialized Technical Assistance Center
Type of intervention: AV= start-up – MA= maintenance – GA=warranty – AB=subscription – RI= repair			



Water purification - ozone
Swimming pool systems - osmosis
BWT ITALIA Srl
Via Vivaio, 8 20122 Milan
Tel. (+39) 02 20.46.343



**USE
INFORMATION**

Despite the attention paid to the creation of this manual, BWT ITALIA SRL cannot guarantee the accuracy of all the information contained and cannot be held responsible either for the errors that this could cause, or for the damages that could result from usage or application.

The material products, software and services presented in this document are subject to updates and improvements in terms of performance and operating characteristics.

BWT ITALIA SRL reserves the right to make any changes without notice.

This technical information takes into account the Company's experiences and applies to normal use of the product as described above; different uses must be authorized from time to time. For particular or difficult cases it is necessary to stipulate an agreement with our Technical Assistance and Consultancy Centers present throughout the national territory to check the results of use of the product and approve any corrections." BWT ITALIA SRL reserves the right to make any modification to its products. According to the law, even partial reproduction of this document is prohibited and it remains the property of the company.

Addresses and telephone numbers of our technical assistance and consultancy organization as well as for the sale of our products and systems can also be found in the yellow pages under the heading "water purification - systems, appliances, swimming pools".

Release: 3/2022 **Ed.** 1/22

Code: